









# 5/2-directional valve, Series 581, size 1

- ISO 5599-1
- ISO 1
- 5/2
- double solenoid
- $Q_n = 1400 \text{ l/min}$
- Compressed air connection output Base plate ISO 5599-1
- Electrical connection Plug, EN 175301-803, form A
- Manual override with detent, without detent

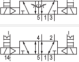

Type	Spool valve
Sealing principle	Soft sealing
Blocking principle	Single base plate principle
Connection type	Plate connection
Standards	ISO 5599-1, ISO 1
Working pressure min./max.	See table below
Control pressure min./max.	1,5 ... 10 bar
Ambient temperature min./max.	-15 ... 50 °C
Medium temperature min./max.	-15 ... 50 °C
Medium	Compressed air
Max. particle size	50 µm
Oil content of compressed air	0 ... 5 mg/m <sup>3</sup>
Nominal flow $Q_n$	1400 l/min
Flow conductance C	5,2 l/(s*bar)
Protection class with connection	IP65
Compatibility index	14
Duty cycle	100 %
Typ. switch-on time	13 ms
Typ. switch-off time	13 ms
Mounting screw	with hexagon socket
Mounting screw tightening torque	2 Nm
Weight	0,5 kg

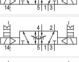
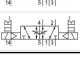
## Technical data

Part No.		MO	Operational voltage DC	Operational voltage AC 50 Hz
5811290650			24 V	-
5811290450			-	230 V
5811291650			24 V	-
5811291450			-	230 V
5811292650			24 V	-
5811292450			-	230 V
5811293650			24 V	-
5811293450			-	230 V

Part No.	Voltage tolerance DC	Voltage tolerance AC 50 Hz	Power consumption DC	Holding power AC 50 Hz
5811290650	-10% / +10%	-	2 W	-
5811290450	-	-10% / +10%	-	4,8 VA
5811291650	-10% / +10%	-	2 W	-
5811291450	-	-10% / +10%	-	4,8 VA
5811292650	-10% / +10%	-	2 W	-
5811292450	-	-10% / +10%	-	4,8 VA
5811293650	-10% / +10%	-	2 W	-
5811293450	-	-10% / +10%	-	4,8 VA

Part No.	Switch-on power AC 50 Hz	Pilot	Working pressure min./max.	Compatibility index
5811290650	-	Internal	1,5 ... 10 bar	14
5811290450	7 VA	Internal	1,5 ... 10 bar	14
5811291650	-	Internal	1,5 ... 10 bar	14
5811291450	7 VA	Internal	1,5 ... 10 bar	14
5811292650	-	External	-0,95 ... 10 bar	14
5811292450	7 VA	External	-0,95 ... 10 bar	14
5811293650	-	External	-0,95 ... 10 bar	14
5811293450	7 VA	External	-0,95 ... 10 bar	14

Part No.	Electrical connection Pilot valve	Throttle
5811290650	Plug EN 175301-803, form A	-
5811290450	Plug EN 175301-803, form A	-
5811291650	Plug EN 175301-803, form A	with throttle
5811291450	Plug EN 175301-803, form A	with throttle
5811292650	Plug EN 175301-803, form A	-
5811292450	Plug EN 175301-803, form A	-
5811293650	Plug EN 175301-803, form A	with throttle
5811293450	Plug EN 175301-803, form A	with throttle

Nominal flow  $Q_n$  at 6 bar and  $\Delta p = 1$  bar, MO = Manual override, An operating pressure of up to 16 bar is possible in the version with manual override without detent.

## Technical information

The min. control pressure must be adhered to, since otherwise faulty switching and valve failure may result!

The pressure dew point must be at least 15 °C under ambient and medium temperature and may not exceed 3 °C .

The oil content of compressed air must remain constant during the life cycle.

Use only the approved oils from AVENTICS. Further information can be found in the "Technical information" document (available in the MediaCentre).

## Technical information

Housing	Aluminum
Seals	Acrylonitrile butadiene rubber

## Dimensions

### Dimensions

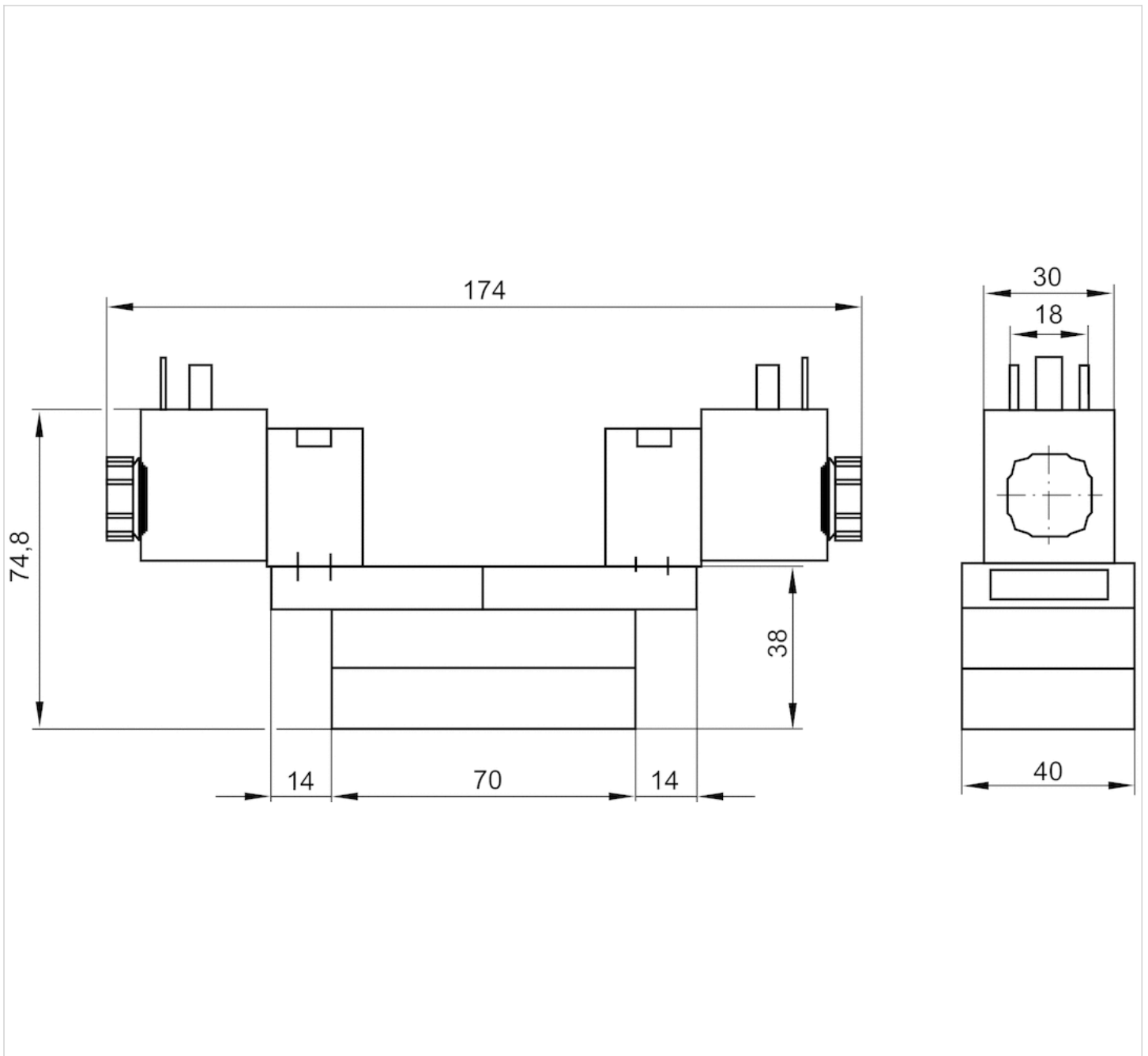

# Efficient pneumatic solutions, our program: cylinders and drives, valves and valve systems, air supply management



Visit us: [Emerson.com/Aventics](https://www.emerson.com/Aventics)

Your local contact: [Emerson.com/contactus](https://www.emerson.com/contactus)



[Emerson.com](https://www.emerson.com)



[Facebook.com/EmersonAutomationSolutions](https://www.facebook.com/EmersonAutomationSolutions)



[LinkedIn.com/company/Emerson-Automation-Solutions](https://www.linkedin.com/company/Emerson-Automation-Solutions)



[Twitter.com/EMR\\_Automation](https://twitter.com/EMR_Automation)

An example configuration is depicted on the title page. The delivered product may thus vary from that in the illustration. Subject to change. This Document, as well as the data, specifications and other information set forth in it, are the exclusive property of AVENTICS GmbH. It may not be reproduced or given to third parties without its consent. Only use the AVENTICS products shown in industrial applications. Read the product documentation completely and carefully before using the product. Observe the applicable regulations and laws of the respective country. When integrating the product into applications, note the system manufacturer's specifications for safe use of the product. The data specified only serve to describe the product. No statements concerning a certain condition or suitability for a certain application can be derived from our information. The information given does not release the user from the obligation of own judgement and verification. It must be remembered that the products are subject to a natural process of wear and aging.

The Emerson logo is a trademark and service mark of Emerson Electric Co. Brand logotype are registered trademarks of one of the Emerson family of companies. All other marks are the property of their respective owners. © 2020 Emerson Electric Co. All rights reserved.  
2020-12



**CONSIDER IT SOLVED™**